

① Board dimensions (top view)  
Scale 3:1

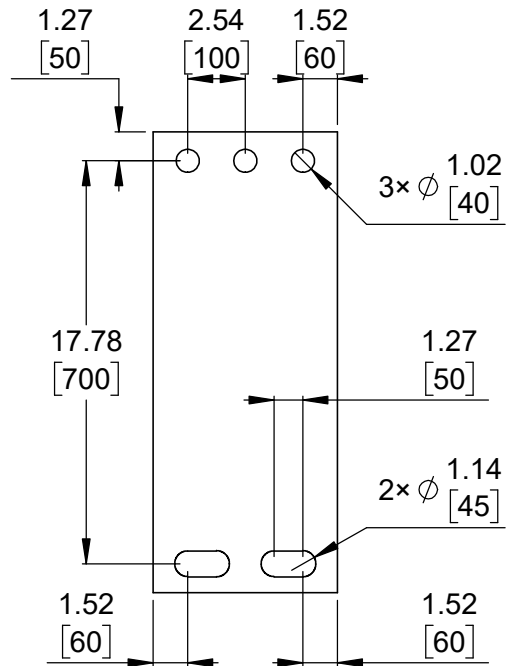

② Connector callouts (bottom view)  
Scale 3:1

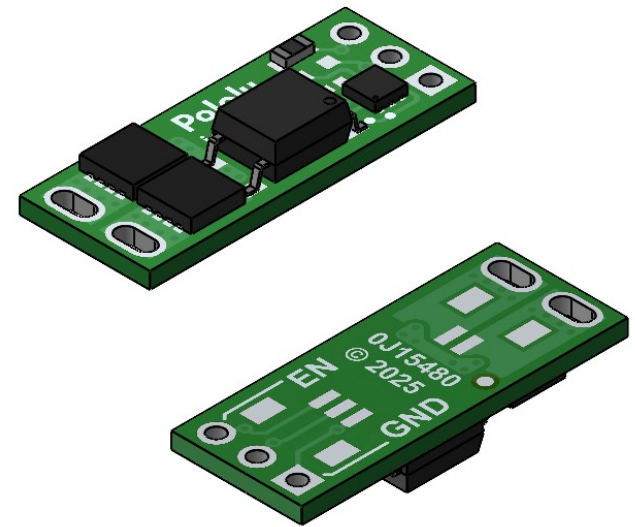

③ Isometric view  
Scale 3:1

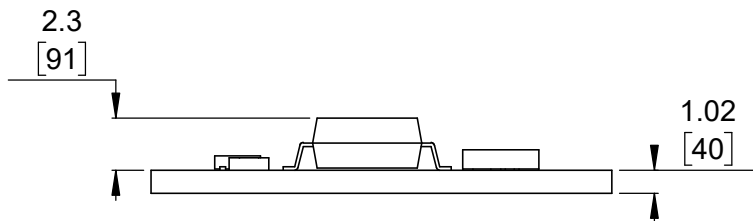

④ Profile  
Scale 3:1

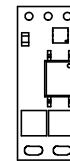

⑤ Actual size  
Scale 1:1

1. To get the specified scale, select 100% in print settings.
2. Drill location tolerance:  $\pm 0.1$  [ $\pm 5$ ].
3. Board edge tolerance:  $\pm 0.3$  [ $\pm 10$ ].

<https://www.pololu.com/product/5420>

Name: Pololu Isolated Solid State Relay/Switch, SPST		Item number: 5420, 5421
Drawing date: 27 March 2026	Dev code: iso01a	 © 2026 Pololu Corporation
Units: mm [mil]	Material: mixed	

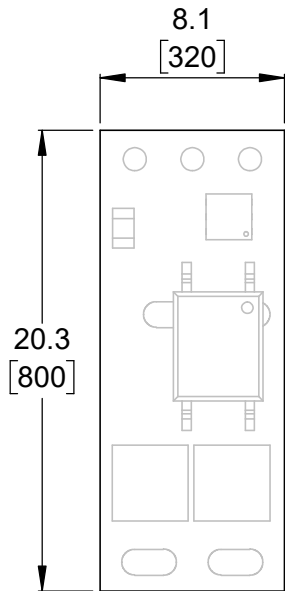

1 Board dimensions (top view)  
Scale 3:1

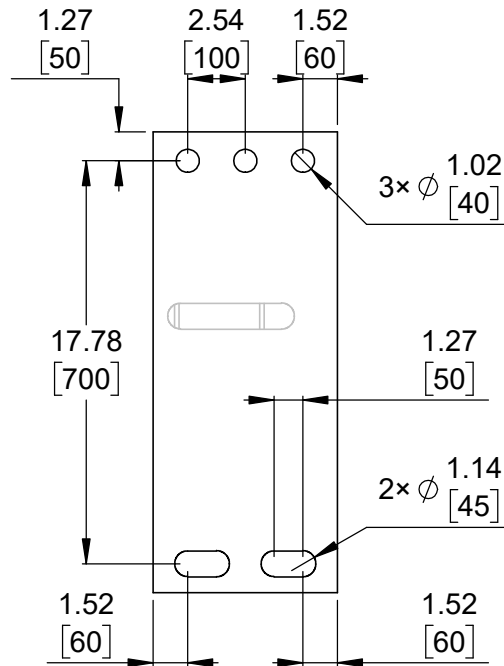

2 Connector callouts (bottom view)  
Scale 3:1

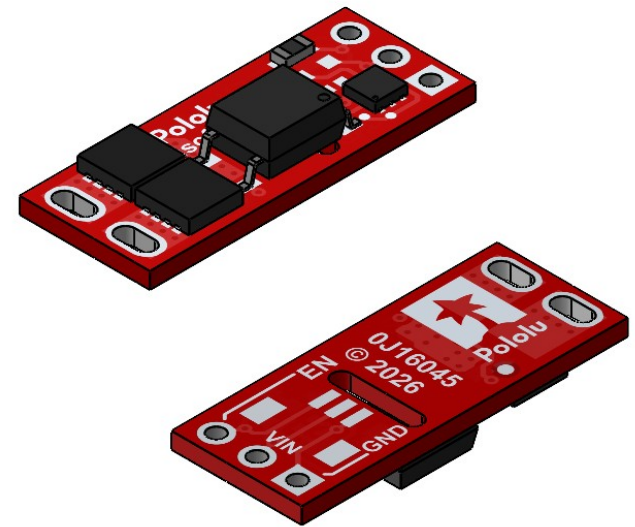

3 Isometric view  
Scale 3:1

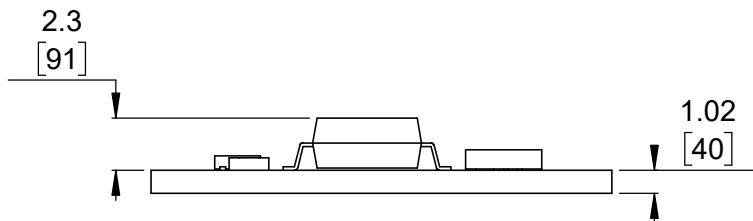

4 Profile  
Scale 3:1

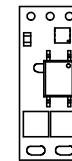

5 Actual size  
Scale 1:1

1. To get the specified scale, select 100% in print settings.
2. Drill location tolerance:  $\pm 0.1$  [ $\pm 5$ ].
3. Board edge tolerance:  $\pm 0.3$  [ $\pm 10$ ].

<https://www.pololu.com/product/5426>

Name: Pololu Isolated Solid State Relay/Switch, SPST, 100V, 4.5A		Item number: 5426
Drawing date: 27 March 2026	Dev code: iso01b	 © 2026 Pololu Corporation
Units: mm [mil]	Material: mixed	